

SNW-Series Adapter Sleeves

Shaft Sizes 1-7/16 in – 6-15/16 in

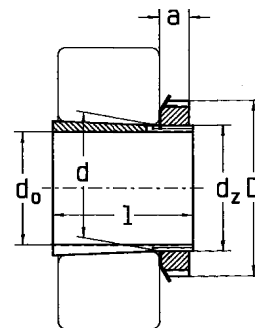

Dimensions d _o Bore	Adapter P/N			Thread Pitch Diameter	Threads Per Inch	Weight ~	Components		Adapter Fits the Following Bearings	
	d	l	a				Nut	Washer		
	in					kg lbs				
1 7/16"	1.772	1.584	0.662	SNW 09	1.7277	18	0.6	N 09	W 09	2209K, 1309K, 22209K 2309K, 22309K
	1.772	2.133	0.662	SNW 109	1.7277	18	0.7	N 09	W 09	
1 11/16"	1.969	1.765	0.724	SNW 10	1.9277	18	0.7	N 10	W 10	2210K, 1310K, 22210K 2310K, 22310K
	1.969	2.394	0.724	SNW 110	1.9277	18	0.8	N 10	W 10	
1 15/16"	2.165	1.845	0.729	SNW 11	2.1174	18	0.8	N 11	W 11	2211K, 1311K, 22211K 2311K, 22311K
	2.165	2.516	0.729	SNW 111	2.1174	18	0.9	N 11	W 11	
2 3/16"	2.559	2.100	0.792	SNW 13	2.5084	18	1.3	N 13	W 13	2213K, 1313K, 22213K 2313K, 22313K
	2.559	2.771	0.792	SNW 113	2.5084	18	1.7	N 13	W 13	
2 7/16"	2.953	2.296	0.895	SNW 15	2.8752	12	2.2	AN 15	W 15	2215K, 1315K, 22215K 2315K, 22315K
	2.953	3.084	0.895	SNW 115	2.8752	12	2.9	AN 15	W 15	
2 11/16"	3.150	2.376	0.895	SNW 16	3.0790	12	2.4	AN 16	W 16	2216K, 1316K, 22216K 2316K, 22316K
	3.150	3.204	0.895	SNW 116	3.0790	12	3.1	AN 16	W 16	
2 15/16"	3.346	2.486	0.926	SNW 17	3.2812	12	2.9	AN 17	W 17	2217K, 1317K, 22217K 2317K, 22317K
	3.346	3.312	0.926	SNW 117	3.2812	12	3.4	AN 17	W 17	
3 3/16"	3.543	2.646	1.010	SNW 18	3.4682	12	3.0	AN 18	W 18	2218K, 1318K, 22218K 2318K, 23218K, 22318K
	3.543	3.553	1.010	SNW 118	3.4682	12	3.9	AN 18	W 18	
3 7/16"	3.937	2.869	1.073	SNW 20	3.8592	12	4.3	AN 20	W 20	2220K, 1320K, 22220K 23220K, 22320K
	3.937	3.971	1.073	SNW 120	3.8592	12	6.2	AN 20	W 20	
3 15/16"	4.331	3.206	1.135	SNW 22	4.2648	12	5.0	AN 22	W 22	2222K, 1322K, 22222K 23222K, 22322K
	4.331	4.348	1.135	SNW 122	4.2648	12	6.4	AN 22	W 22	
4 3/16"	4.724	3.466	1.166	SNW 24	4.6558	12	6.6	AN 24	W 24	2224K 22324K 23024K
	4.724	4.648	1.166	SNW 124	4.6558	12	7.8	AN 24	W 24	
	4.724	2.947	1.250	SNW 3024	4.6538	12	6.1	N 024	W 024	
4 7/16"	5.118	3.762	1.229	SNW 26	5.0458	12	9.7	AN 26	W 26	2226K 22326K 23026K
	5.118	4.982	1.229	SNW 126	5.0458	12	12.4	AN 26	W 26	
	5.118	3.237	1.313	SNW 3026	5.0458	12	7.5	N 026	W 026	
4 15/16"	5.512	3.981	1.291	SNW 28	5.4368	12	10.3	AN 28	W 28	2228K 22328K 23028K
	5.512	5.323	1.291	SNW 128	5.4368	12	13.0	AN 28	W 28	
	5.512	3.340	1.375	SNW 3028	5.4368	12	8.4	N 028	W 028	
5 3/16"	5.906	4.241	1.354	SNW 30	5.8273	12	15.8	AN 30	W 30	22230K 22330K 23030K
	5.906	5.621	1.354	SNW 130	5.8278	12	18.0	AN 30	W 30	
	5.906	3.492	1.406	SNW 3030	5.8278	12	9.7	N 030	W 030	
5 7/16"	6.299	4.578	1.510	SNW 32	6.1953	8	15.6	AN 32	W 32	22232K 22332K 23032K
	6.299	5.920	1.510	SNW 132	6.1953	8	18.1	AN 32	W 32	
	6.299	3.711	1.468	SNW 3032	6.1953	8	11.8	N 032	W 032	
5 15/16"	6.693	4.847	1.541	SNW 34	6.5703	8	19.4	AN 34	W 34	22234K 22334K 23034K
	6.693	6.188	1.541	SNW 134	6.5703	8	21.0	AN 34	W 34	
	6.693	4.019	1.500	SNW 3034	6.5703	8	13.3	N 034	W 034	
6 7/16"	7.087	5.038	1.573	SNW 36	6.9773	8	20.5	AN 36	W 36	22236K 22336K 23036K
	7.087	6.456	1.573	SNW 136	6.9773	8	22.4	AN 36	W 36	
	7.087	4.337	1.531	SNW 3036	6.9773	8	15.2	N 036	W 036	
6 15/16"	7.480	5.261	1.604	SNW 38	7.3833	8	23.4	AN 38	W 38	22238K 22338K 23038K
	7.480	6.758	1.604	SNW 138	7.3833	8	28.1	AN 38	W 38	
	7.480	4.412	1.594	SNW 3038	7.3833	8	16.7	N 038	W 038	

Sleeve designations printed in bold face type are currently in our manufacturing schedule. Those shown in normal face type are made to order.

SNW-Series Adapter Sleeves

Shaft Sizes 7-13/16 in – 13-15/16 in

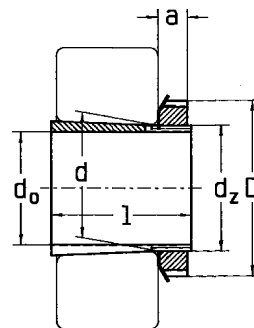

Dimensions d _o Bore	Dimensions			Adapter P/N	Thread Pitch Diameter	Threads Per Inch	Weight ~	Components		Adapter Fits the Following Bearings
	d	l	a					Nut	Washer	
	in						kg lbs			
7 3/16"	7.874	5.484	1.666	SNW 40	7.7521	8	30.7	AN 40	W 40	22240K
	7.874	7.095	1.666	SNW 140	7.7521	8	35.7	AN 40	W 40	22340K
	7.874	4.750	1.656	SNW 3040	7.7521	8	19.7	N 040	W 040	23040K
7 15/16"	8.661	5.901	1.698	SNW 44	8.5378	8	32.3	N 44	W 44	22244K
	8.661	5.130	1.750	SNW 3044	8.8378	8	24.4	N 044	W 044	23044K
8 15/16"	9.449	5.432	1.968	SNP 3048	9.3245	6	32.2	N 048	P 48	23048K
9 7/16"	10.236	6.019	2.125	SNP 3052	10.0742	6	41.1	N 052	P 52	23052K
10 7/16"	11.024	6.191	2.219	SNP 3056	10.8852	6	45.4	N 056	P 56	23056K
10 15/16"	11.811	6.727	2.281	SNP 3060	11.6662	6	58.9	N 060	P 60	23060K
11 15/16"	12.598	6.946	2.375	SNP 3064	12.4439	6	65.7	N 064	P 64	23064K
12 7/16"	13.386	7.543	2.531	SNP 3068	13.191	5	77.8	N 068	P 68	23068K
13 7/16"	14.173	7.579	2.531	SNP 3072	14.022	5	86.2	N 072	P 72	23072K
13 15/16"	14.961	7.743	2.656	SNP 3076	14.809	5	94.3	N 076	P 76	23076K

Sleeve designations printed in bold face type are currently in our manufacturing schedule. Those shown in normal face type are made to order.